

MECHANICAL BOTTOMER

MODEL:

MANUAL

WARNING

BEFORE OPERATING THIS STAPLER. ALL OPERATORS SHOULD STUDY THIS MANUAL TO UNDERSTAND AND FOLLOW THE SAFETY WARNINGS AND INSTRUCTIONS. KEEP THESE INSTRUCTIONS WITH THE STAPLER FOR FUTURE REFERENCE. IF YOU HAVE ANY QUESTION, CONTACT YOUR DISTRIBUTOR.

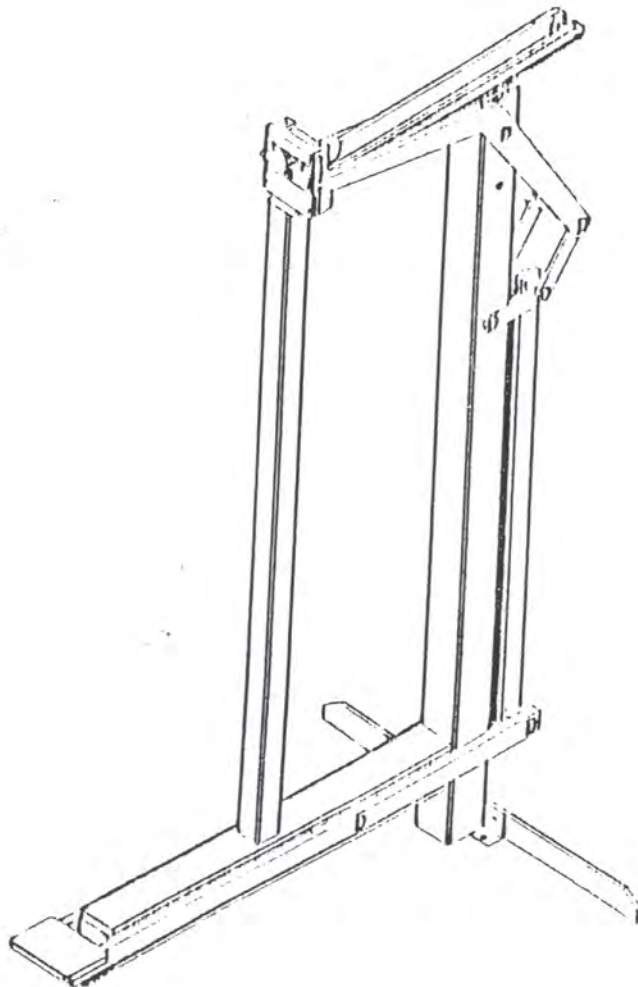

TOOL SPECIFICATIONS

- MODEL OF TOOL:.....
- DIMENSIONS
(LENGTH X HEIGHT X WIDTH).....910MM X 600MM X 1245MM
- WEIGHT (WITHOUT FASTENERS).....26.8 KGS
- STAPLES SPECIFICATION.....CROWN
LENGTH 15MM, 18MM
- STAPLES CAPACITY.....200 PCS

SAFETY INSTRUCTIONS

READ THIS MANUAL AND UNDERSTAND ALL SAFETY INSTRUCTIONS BEFORE OPERATION THE TOOL. IF YOU HAVE ANY QUESTIONS, PLEASE CONTACT OUR AUTHORIZED REPRESENTATIVES.

WARNING

1. AT THE WORKPLACE, ALWAYS WEAR THE PROTECTIVE EQUIPMENT SUCH AS SAFETY GLASSES, HEAD PROTECTION.
2. DO NOT PLACE YOUR HEAD OR ANY PART OF YOUR BODY IN THE STAPLE CLINCHING AREA-BETWEEN COVER A (016) AND MOLD (046).
3. IF THERE IS NOT A CARTON IN POSITION. DO NOT PRESS THE STEP BOARD SET (044) DOWN.

ASSEMBLY

1. FIND A SUITABLE PLACE.
2. OPEN THE PACKING AND STAND THE MACHINE UP.
3. USE 6 MM HEX. WRENCH AND 13 MM SPANNER TO ASSEMBLE THE BALANCER (049).
4. ASSEMBLE THE SPRING (038).

OPERATING

1. PULL PUSHER (026) BACKWARDS UNTIL IT STOPS ON PUSHER PIVOTS (024). THEN ROTATE PUSHER (026) INTO POSITION.
2. INSERT 4 STICKS OF APPROPRIATE STAPLES INTO THE MAGAZINE (020) FROM BACK. LET THE STAPLES SLIDE FORWARD TO THE FRONT OF THE MAGAZINE (020).
3. PULL PUSHER (026) BACK TO UPRIGHT POSITION AND GENTLY LET THE PUSHER (026) SLIDE FORWARD AGAINST THE STAPLES. DO NOT LET THE PUSHER (026) SLIDE FORWARD TO ENGAGE STAPLES AT HIGH SPEED OR IT MAY DEFORM THE STAPLES OR DAMAGE THE MACHINE.
4. PUT THE CARTON INTO POSITION.
NOTE: STRAIGHT THE CENTER LINE OF CARTON TO THE COVER A'S (016) CENTER LINE.
5. PRESS THE STEP BOARD SET (044) DOWN BY FOOT UNTIL IT STOPS. THEN RELEASE THE STEP BOARD SET (044)
NOTE: IF THERE IS NOT A CARTON IN POSITION, DO NOT PRESS THE STEP BOARD SET (044) DOWN.

CLEARING A JAM

1. PULL THE PUSHER (026) BACKWARDS. AND ROTATE INTO POSITION. THEN REMOVE THE REST OF THE STAPLES.
2. REMOVE COVER A (016) WITH 4 MM HEX. WRENCH.
3. CLEAR THE JAM.
4. ASSEMBLE COVER A (016).

MAINTENANCE

1. KEEP THE MACHINE CLEARLY.
2. FEED OIL ON EVERY SHAFT BEFORE OPERATING EVERYDAY.

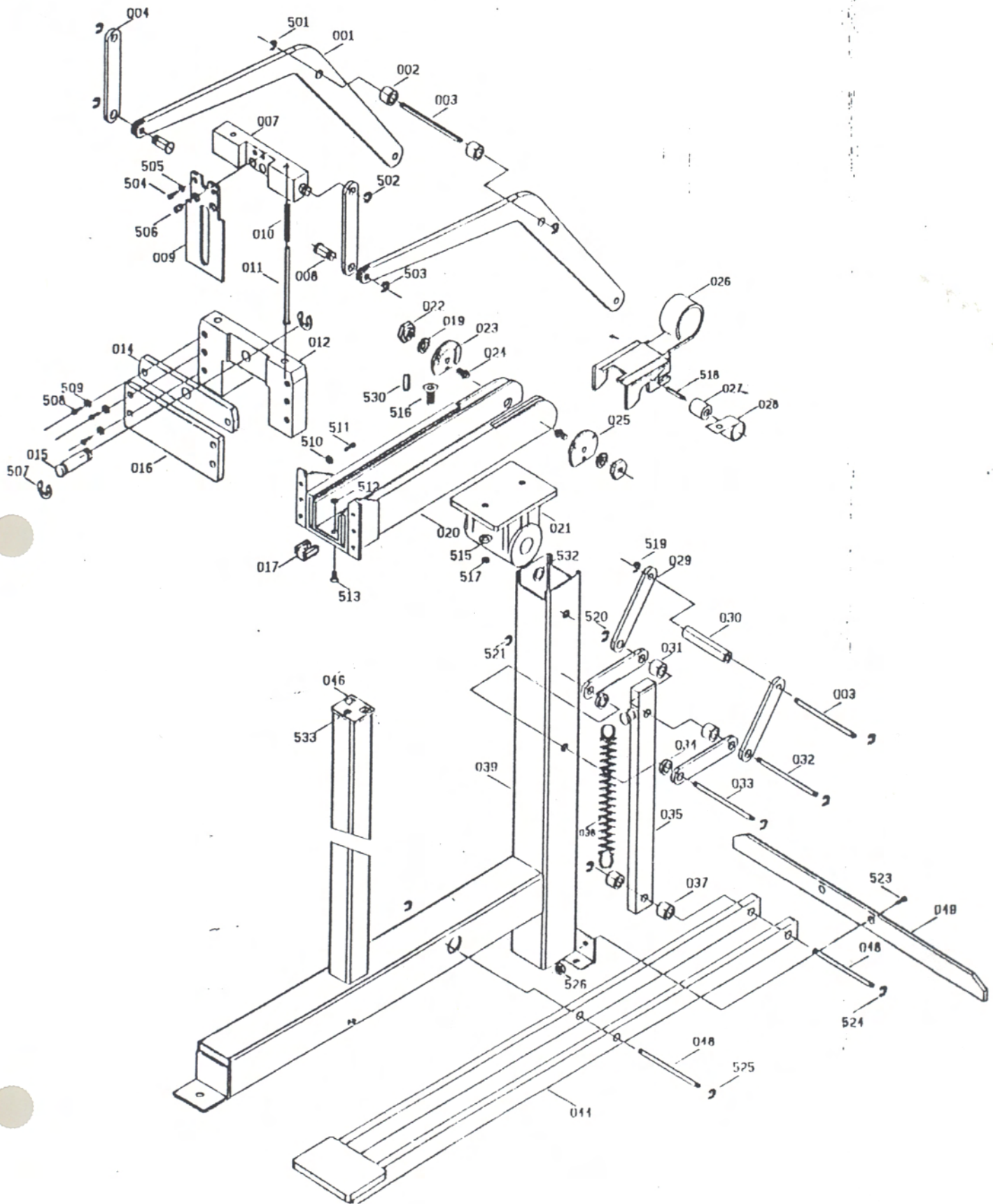

Model No. : CMB-S

Item	Part No.	Description	Q'ty	Specification
001	A00600101	LINK 1	2	
002	A00603401	TUBE	2	
003	A00603201	SHAFT E	2	
004	A00600401	LINK 2	2	
007	A00600703	DRIVER SEAT	1	
008	A00600801	SHAFT C	2	
009	A00600904	DRIVER	1	35
009	A00600905	DRIVER	1	32
009	A00600906	DRIVER	1	34
010	A00601002	SPRING	2	
011	A00601103@	SPRING SHAFT	2	
012	A00601202	MAGAZINE SEAT	1	35
012	A00601203	MAGAZINE SEAT	1	32
012	A00601204	MAGAZINE SEAT	1	34
014	A00601402	COVER B	1	35
014	A00601403	COVER B	1	32
014	A00601404	COVER B	1	34
015	A00601502	SHAFT D	1	
016	A00601602	COVER A	1	35
016	A00601603	COVER A	1	32
016	A00601604	COVER A	1	34
017	A00105601	BRACKET	1	
019	A00607001	WASHER	2	
020	CMB-S-35-P3	MAGAZINE UNIT	1	35
020	CMB-S-32-P3	MAGAZINE UNIT	1	32
020	CMB-S-34-P3	MAGAZINE UNIT	1	34
021	A00602101	BRACKET	1	
022	A00103102	NUT	2	
023	A00103903@	RIGHT PUSHER GUIDE	1	
024	A00103203	ROD	2	
025	A00103904@	LEFT PUSHER GUIDE	1	
026	A00103707@	PUSHER SET	1	35
026	A00103706@	PUSHER SET	1	32
026	A00103708@	PUSHER SET	1	34
027	A00103501	ROLLER	1	
028	A00602801	SPRING	1	
029	A00602901	LING 3	4	
030	A00603002	TUBE	1	
031	A00603701	TUBE	2	
032	A00603202	SHAFT E	1	

Item	Part No.	Description	Q'ty	Specification
033	A00603302	SHAFT F	1	
034	A00603402	TUBE	2	
035	A00603501@	LING 4 SET	1	
037	A00603701	TUBE	2	
038	A00603801	SPRING	1	
039	A00603901@	BODY SET	1	
044	A00604401@	SETP BOARD SET	1	
046	A00604601	MOLD	1	35
046	A00604602	MOLD	1	32,34
048	A00604801	SHAFT G	2	
049	A00604901	BALANCER	1	
501	BAF11002	E-RING	2	φ 10
502	BAF10502	E-RING	2	φ 5
503	BAF10502	E-RING	2	φ 5
504	BAC0404102	HEX.SOC.HD.BOLT	2	M4 x 0.7-10
505	BAE01042	SPRING WASHER	2	M4
506	BAA060016	SPRING PIN	2	φ 6-16
507	BAF10602	E-RING	2	φ 6
508	BAC0405202	HEX.SOC.HD.BOLT	6	M5 x 0.8-10
509	BAE01052	SPRING WASHER	6	M5
510	BAE01052	SPRING WASHER	6	M5
511	BAC0405082	HEX. SOC. HD. BOLT	6	M5x0.8-8
512	BAD001041	LOCK NUT	1	M4 x 0.7
513	BAC0204202	HEX.SOC.FLAT COUNTER SUNK HD. SCREW	1	M4 x 0.7-20
515	BAE03051	WASHER	4	φ 5.1x φ 12x0.8T
516	BAC0205202	HEX.SOC.FLAT COUNTER SUNK HD. SCREW	2	M5 x 0.8-20
517	BAD01051	LOCK NUT	2	M5 x 0.8
518	BAA040016	SPRING PIN	1	φ 4-16
519	BAF11002	E-RING	2	φ 10
520	BAF11002	E-RING	2	φ 10
521	BAF11002	E-RING	2	φ 10
523	BAC0408162	HEX.SOC.HD.BOLT	2	M8 x 1.25-16
524	BAF11002	E-RING	2	φ 10
525	BAF11002	E-RING	2	φ 10
526	BAD01081	LOCK NUT	2	M8 x 1.25
530	BAA040012	SPRING PIN	4	φ 4-12
532	BAE03142	WAVE WASHER	2	φ 14.5 x φ 21
533	BAC0204082	HEX.SOC.FLAT COUNTER SUNK HD. SCREW	1	M4 x 0.7-8